



WARNING!!! The magnets used on the Safe-T-Stik are **EXTREMELY POWERFUL** and can be **VERY DANGEROUS** when loose. **NEVER** have more than one magnet in your hand or in a work area at a time. Use **EXTREME CAUTION** when handling magnets around metal and other magnets. These magnets can cause **SEVERE INJURIES** to fingers, hands and can damage other objects or surfaces if they come into contact. **Keep magnets at least 2 feet apart from one another. If 2 magnets come in contact with one another, they are almost impossible to separate!**

Items You'll Need

A 5/16 Allen Wrench

(For 3" magnets)

A 1/4 Allen Wrench

(For 2.5" magnets)

A Bench Top Vise

Work Gloves

What's Included in the Kit

2 New Magnets (3" or 2.5" Dia)

New Product Specific Hardware

2 Syringes of Thread Locker*

(* Not included for Multi-Grab IV magkits or when pre-applied to bolt end)

Hardware by Product

2 ea - 3/8 X 1" Bolt = (Certain Safe-T-Stik Models & Multi-Grab II & III)

2 ea - 5/16 X 3/4" Bolt = (Safe-T-Stik Lite Models)

2 ea - 3/8 X 1 1/2" Bolt = (Magna-Grab & Multi-Grab IV)

2 ea - 3/8 Lock Nut = (Multi-Grab IV)

2 ea - 3/8 SS Washer = (Multi-Grab IV)

NOTE: Magnet Kits are built to replace magnets for specific tools. Not all hardware is in each kit. Syringes of thread locker may not be included in a kit if thread locker is pre-applied on bolt end or if the specific kit ordered does not require it.

SAFE-T-STIK PRODUCTS MAGNET REPLACEMENT STEPS:

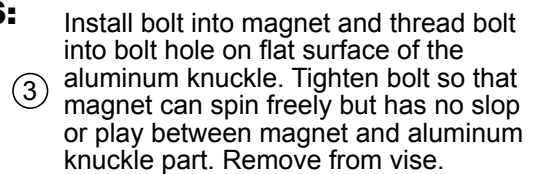
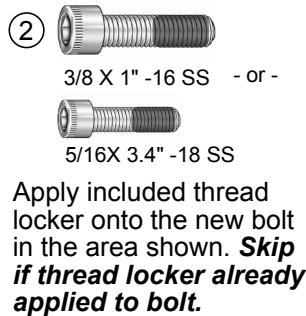
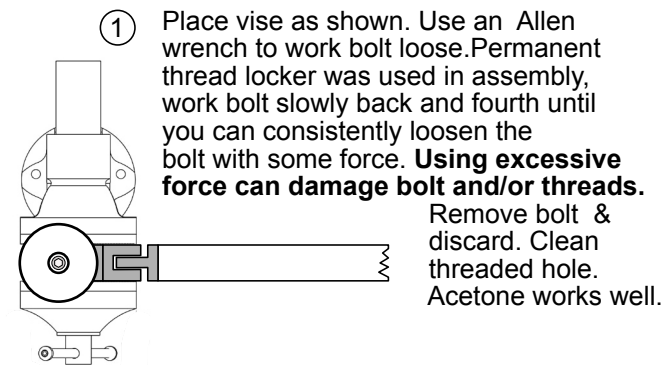

Let rest for 2 to 4 hours before use if liquid thread locker was used.

Pack old or damaged magnet in cardboard, tape it securely and dispose of properly.

MULTI-GRAB PRODUCTS MAGNET REPLACEMENT STEPS:

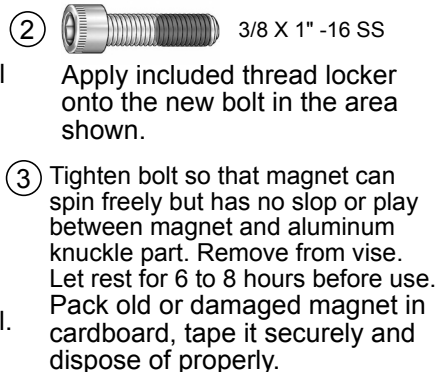
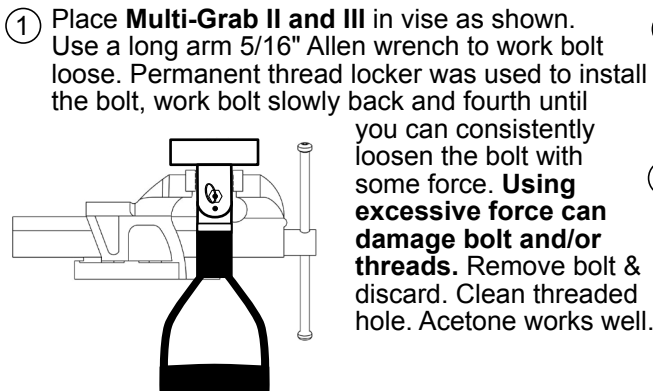

Multi-Grab IV

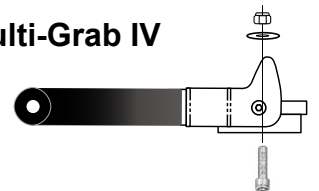

Remove damaged or worn magnet by holding the 3/8" lock nut with a wrench and use a 5/16" Allen wrench to loosen magnet bolt. Install new magnet by inserting the magnet bolt through the magnet and magnet base. make sure the washer goes over the bolt and tighten the lock nut so that the magnet is tight against the base but spins easily. No slop. **No thread locker is required.**

MAGNA-GRAB PRODUCT MAGNET REPLACEMENT STEPS:

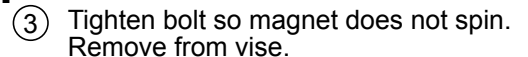
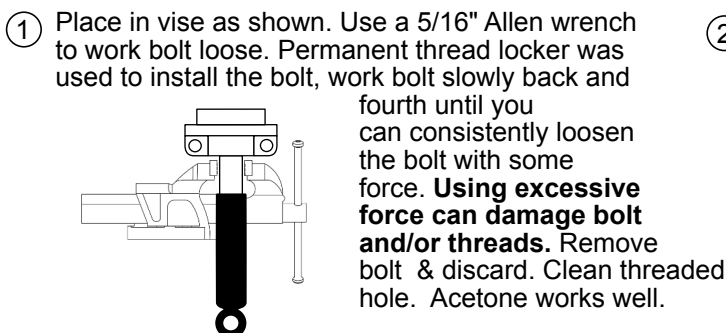

Let rest for 2 to 4 hours before use if liquid thread locker was used.

Pack old or damaged magnet in cardboard, tape it securely and dispose of properly.